

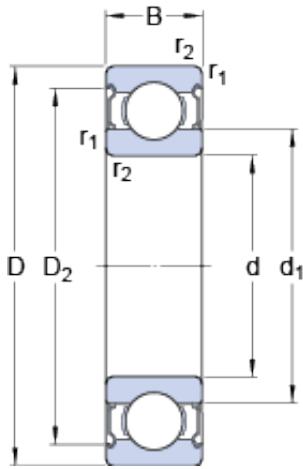

Bearing import and Export Co., Ltd



17 mm x 26 mm x 5 mm SKF 61803-2Z deep groove ball bearings

Bearing No. 61803-2Z

61803-2Z Bearing 2D drawings and 3D CAD models

Size	26x17x5 mm
Bore Diameter	26 mm
Outer Diameter	17 mm
Width	5 mm
d	17 mm
D	26 mm
B	5 mm
d ₁	19.8 mm
D ₂	24.15 mm
r _{1,2} - min.	0.3 mm
d _a - min.	19 mm
d _a - max.	19.6 mm
D _a - max.	24 mm
r _a - max.	0.3 mm
Basic dynamic load rating - C	2 kN
Basic static load rating - C ₀	1.3 kN
Fatigue load limit - P _u	0.054 kN
Reference speed	56000 r/min
Limiting speed	28000 r/min
Calculation factor - k _r	0.015
Calculation factor - f ₀	14.1
Category	Single Row Ball Bearings
Inventory	0.0
Manufacturer Name	SKF



Bearing import and Export Co., Ltd

Minimum Buy Quantity	N/A
Weight / Kilogram	0.01
EAN	7316577611543
Product Group	B00308
Enclosure	2 Metal Shields
Precision Class	ABEC 1 ISO P0
Maximum Capacity / Filling Slot	No
Rolling Element	Ball Bearing
Snap Ring	No
Internal Special Features	No
Cage Material	Steel
Internal Clearance	C0-Medium
Inch - Metric	Metric
Long Description	17MM Bore; 26MM Outside Diameter; 5MM Outer Race Diameter; 2 Metal Shields; Ball Bearing; ABEC 1 ISO P0; No Filling Slot; No Snap Ring; No Internal Special Features
Category	Single Row Ball Bearing
UNSPSC	31171504
Harmonized Tariff Code	8482.10.50.68
Noun	Bearing
Keyword String	Ball
Manufacturer URL	http://www.skf.com
Manufacturer Item Number	61803 2Z
Weight / LBS	0.02
Outside Diameter	1.024 Inch 26 Millimeter
Outer Race Width	0.197 Inch 5 Millimeter
Bore	0.669 Inch 17 Millimeter
bore diameter:	17 mm
static load capacity:	1.27 kN



Bearing import and Export Co., Ltd

outside diameter:	26 mm
precision rating:	Not Rated
overall width:	5 mm
finish/coating:	Uncoated
bore type:	Round
cage material:	Steel
closure type:	Double Shielded
outer ring width:	5 mm
row type & fill slot:	Single Row Non-Fill Slot
fillet radius:	0.3 mm
internal clearance:	C0
maximum rpm:	28000 RPM
dynamic load capacity:	2.03 kN
series:	61
d_1	19.8 mm
D_2	0 mm
$r_{1,2}$ min.	0.3 mm
d_a min.	19 mm
d_a max.	19.6 mm
D_a max.	24 mm
r_a max.	0.3 mm
Basic dynamic load rating C	2.03 kN
Basic static load rating C_0	1.27 kN
Fatigue load limit P_u	0.054 kN
Calculation factor k_r	0.015
Calculation factor f_0	14.1
Mass bearing	0.0082 kg