

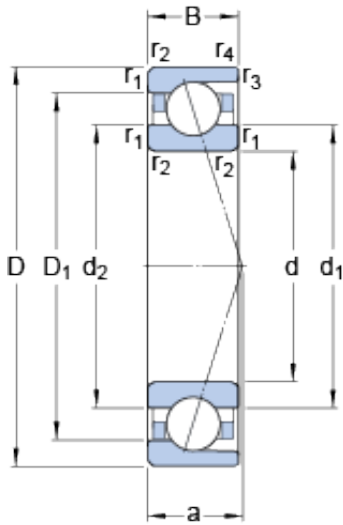

Bearing import and Export Co., Ltd



7026 ACD/HCP4A Bearing 2D drawings and 3D CAD models

130 mm x 200 mm x 33 mm SKF 7026
ACD/HCP4A angular contact ball bearings

Bearing No. 7026 ACD/HCP4A

Size	200x130x33 mm
Bore Diameter	200 mm
Outer Diameter	130 mm
Width	33 mm
d	130 mm
D	200 mm
B	33 mm
d ₁	151.6 mm
d ₂	151.6 mm
D ₁	178.4 mm
r _{1,2} - min.	2 mm
r _{3,4} - min.	1 mm
a	55.2 mm
d _a - min.	139 mm
d _b - min.	139 mm
D _a - max.	191 mm
D _b - max.	195 mm
r _a - max.	2 mm
r _b - max.	1 mm
d _n	156.4 mm
Basic dynamic load rating - C	140 kN
Basic static load rating - C ₀	150 kN
Fatigue load limit - P _u	4.9 kN
Limiting speed for grease	7500 r/min



Bearing import and Export Co., Ltd

Lubrication	
Limiting speed for oil lubrication	12000 mm/min
Ball - D_w	22.225 mm
Ball - z	21
G_{ref}	42 cm ³
Calculation factor - e	0.68
Calculation factor - Y_2	0.87
Calculation factor - Y_0	0.38
Calculation factor - X_2	0.41
Calculation factor - Y_1	0.92
Calculation factor - Y_2	1.41
Calculation factor - Y_0	0.76
Calculation factor - X_2	0.67
Preload class A - G_A	900 N
Preload class B - G_B	1800 N
Preload class C - G_C	3600 N
Preload class D - G_D	7200 N
Calculation factor - f	1.15
Calculation factor - f_1	0.99
Calculation factor - f_{2A}	1
Calculation factor - f_{2B}	1.02
Calculation factor - f_{2C}	1.05
Calculation factor - f_{2D}	1.08
Calculation factor - f_{HC}	1.02
Preload class A	392 N/micron
Preload class B	511 N/micron
Preload class C	677 N/micron
Preload class D	917 N/micron



Bearing import and Export Co., Ltd

d_1	151.6 mm
d_2	151.6 mm
D_1	178.4 mm
$r_{1,2}$ min.	2 mm
$r_{3,4}$ min.	1 mm
d_a min.	139 mm
d_b min.	139 mm
D_a max.	191 mm
D_b max.	195 mm
r_a max.	2 mm
r_b max.	1 mm
d_n	156.4 mm
Basic dynamic load rating C	140 kN
Basic static load rating C_0	150 kN
Fatigue load limit P_u	4.9 kN
Attainable speed for grease lubrication	7500 r/min
Attainable speed for oil-air lubrication	12000 r/min
Ball diameter D_w	22.225 mm
Number of balls z	21
Reference grease quantity G_{ref}	42 cm ³
Preload class A G_A	900 N
Static axial stiffness, preload class A	392 N/ μ m
Preload class B G_B	1800 N
Static axial stiffness, preload class B	511 N/ μ m
Preload class C G_C	3600 N
Static axial stiffness, preload class C	677 N/ μ m
Preload class D G_D	7200 N
Static axial stiffness, preload class D	917 N/ μ m



Bearing import and Export Co., Ltd

class D	
Calculation factor f	1.15
Calculation factor f_1	0.99
Calculation factor f_{2A}	1
Calculation factor f_{2B}	1.02
Calculation factor f_{2C}	1.05
Calculation factor f_{2D}	1.08
Calculation factor f_{HC}	1.02
Calculation factor e	0.68
Calculation factor (single, tandem) Y_2	0.87
Calculation factor (single, tandem) Y_0	0.38
Calculation factor (single, tandem) X_2	0.41
Calculation factor (back-to-back, face-to-face) Y_1	0.92
Calculation factor (back-to-back, face-to-face) Y_2	1.41
Calculation factor (back-to-back, face-to-face) Y_0	0.76
Calculation factor (back-to-back, face-to-face) X_2	0.67
Mass bearing	2.67 kg